

Wawne Fest 2019

Saturday 13th July

1pm to 5pm

RAF BBMF Lancaster Bomber Flypast



67th Year. The Wawne Festival is the highlight of the village calendar

Bouncy Castle & Childrens Entertainment

Live Music & Entertainment

Band - Tin Soldier

Mad Magic

Craft Stalls

Belly Dancers

Licensed Bar

**A fun day out for
all the family**

Raffle & Tombola

**Classic Cars
& Tractors**

**Something for
everyone to enjoy**

Catering Outlets

Wawne Primary School - HU7 5XT

NO DOGS ALLOWED

FREE CAR PARK

@WawneFestival

wawnefestival@gmail.com



Adults (16+) - £1.50

Children (2 - 15yrs) - 50p

Under 2s GO FREE

The
Wawne Gazette
July & August 2019

Useful contacts

Parish Council

Chair – Councillor Amanda Hutchinson

Email: cllr.hutchinson@wawneparishcouncil.co.uk

Vice Chair – Councillor Steve Appleyard

Email: cllr.appleyard@wawneparishcouncil.co.uk

Councillor Christine Beaumont

Email: cllr.beaumont@wawneparishcouncil.co.uk

Councillor Jacob Birch

Email: cllr.birch@wawneparishcouncil.co.uk

Councillor Gail Jennison

Email: cllr.jennison@wawneparishcouncil.co.uk

Councillor Andrew Werendel

Email: Councillor.werendel@wawneparishcouncil.co.uk

Clerk – Anne Gawthorpe

Telephone: 01482 225241

Address: 54 Wenlock Street, HU3 1DF

Email: clerk@wawneparishcouncil.co.uk

Mid Holderness Ward Councillors

Jacob Birch councillor.birch@eastriding.gov.uk

John Holtby councillor.holtby@eastriding.gov.uk

Brian Skow councillor.skow@eastriding.gov.uk

East Riding of Yorkshire Council

Email customer.services@eastriding.gov.uk

Telephone 01482 393939

Humberside Police

PCSO Darren Bainton
Email darren.bainton@humberside.pnn.police.uk
Twitter @HPMidHolderness
EMERGENCY - 999 & NON-EMERGENCY - 101

Wawne Primary School

Email wawne.primary@eastriding.gov.uk
Telephone 01482 835599
Address 10 Greens Lane
Twitter @WawnePrimary



Wawne Village Hall

Email Vivbillam@googlemail.com
Telephone 01482 836519

St Peters Church

Vicar Rev. Chris van Straaten 01482838486
Email cjvanstraaten@gmail.com
Churchwarden Julia Smith 01482 834293
Email sunshine61a@yahoo.co.uk
Facebook St.Andrews Church, Sutton Park and St. Peters Church
Wawne

The Waggoners

Telephone 01482 835142

Wawne Festival

Chair Martin Bengé
Email wawnefestival@gmail.com
Facebook & Twitter @WawneFestival



FOWSA

Email fowsa.sch@gmail.com
Address 10 Greens Lane
Telephone 01482 835599

The Editor

Councillor Jacob Birch
5 Oak Square, Wawne, HU7 5XP
Tel: 07926385306
Email: cllr.birch@wawneparishcouncil.co.uk



Article Submissions

All articles must be submitted to me via EMAIL ONLY. This makes the editing of the Wawne Gazette quicker and easier.

Please ensure any submissions are on an EMAIL or attached as an EDITABLE word format (or similar). Please contact me with any questions.

Cover Photo

We would like to use YOUR photos for the Gazette. It can be any photo of the village or surrounding area, if you are lucky it might be used on the cover!

DEADLINE HEADLINE

January Issue	-	15th December
March Issue	-	15th February
May Issue	-	15th April
July Issue	-	15th June
September Issue	-	15th August
November Issue	-	15th October

Any articles submitted to the editor after the above deadlines may not be printed. The editor has the right to refuse to publish any submitted content.

Any images submitted are published on the understanding that all the correct permissions have been gathered by those who submit the images.

The Recreation Ground



needs
you!



A new sub-committee has been formed to help shape the future of our much loved village Recreation Ground and we are looking for members!

- Are you keen to see the Recreation Ground restored?
- Do you have children who use the Recreation Ground?
- Want to shape the future of the Recreation Ground?

If you answered yes to any or all of those then come join us!

For details and to be contacted about news and meetings please email:

cllr.birch@wawneparishcouncil.co.uk

Diary Dates

July

- Saturday 6th Strawberry Teas @ Church @ 2:30pm to 4:30pm
- Wednesday 10th Wawne Fest Set Up Help Needed from 6pm
- Friday 12th Wawne Fest Set Up Help Needed from 4:30pm
 - Saturday 13th Wawne Fest Help Needed from 9am
- Saturday 13th Wawne Fest with FLYPAST

Please remember to send your DIARY DATES to the editor to get them included in this section.

Please include them as a separate part of your submission, if you are sending any articles in together.

Regular Events

- Village Hall Coffee Mornings - Saturdays, look out for the posters
 - Wawne Cake Club - 1st Thursday of each month
- Wawne Parish Council Meetings - 7pm- 1st Thursday of each month

Wawne Defibrillator

If you ever need to use this then the instructions are on the box. Please ring 999 and the call handler will assist you. Nobody in the village has the code to access it.



Parish Council

Your Fire - My smelly washing!

We all have too much rubbish these days but while it's great for you to dispose of that rubbish in a garden fire, the fumes have an adverse effect on your neighbours - those close by and those in the vicinity.

Your neighbours cannot leave washing out to dry, leave a window open, enjoy a barbecue or simply garden because of you and your inconsiderate attitude.

Please think of others before deciding to have a garden fire!

According to GOV.UK

"You cannot get rid of household waste if it will cause pollution or harm people's health. This includes burning it. You can get rid of household or garden waste by composting or recycling it. Contact your local council to find out how to dispose of garden waste and about recycling in your area."

"Complain about a neighbour's bonfire. Your council can issue an 'abatement notice' if a neighbour's bonfire is causing a nuisance. A bonfire must happen frequently to be considered a nuisance. Your neighbour can be fined up to £5,000 if they don't follow the rules of the notice."

Speed Watch

Over the next few months we plan to carry out more Speed-Watch sessions as we cannot to push to meet three objectives (1) Create a Culture Change where people who live in the village show more respect for other road users, pedestrians and animals (2) To gather enough data to get speed controls in place (3) To push for Formal Speed Checks.

We have enough data to act on (2) and have asked the EYRC for speed survey (Strips) on Meaux Road, Sutton Road and Main Street.

We have asked the EYRC about changes to flashing Speed Signs in the hope that we can download data from improved signs - this way we will get a better picture of speeds through the village.

Emergency Plan:

In the event of a major problem (floods, gas leaks etc.) the Emergency Plan will enable the emergency services to contact the right people, meet at the designated place and look after anyone the village who has any additional needs.

Once we have the plan, we'll let you know what to do if such an emergency occurs - where to meet, what to take with you (medicines etc.), what to do with pets etc.

If you think you'd be able to help us and the emergency services if such an emergency occur please contact us via clerk@wawneparishcouncil.co.uk

If you feel that you, a neighbour or a friend might need a bit more help than others then we'd like to ensure that the right help is available to you. We will handle this help and support with the utmost confidentiality and ensure that those helping have the right qualifications/identification. If you think you'd like this additional support contact us on 01482 225241 (Anne Gawthorpe) or via clerk@wawneparishcouncil.co.uk

Traffic Controls

We have a number of issues that we plan to bundle together under one single heading - Traffic controls

- Speed Watch - We plan to undertake more Speed Watch sessions in order to gather enough data for further action to be taken.
- Sutton Road Bridge - We are currently in discussions with ERYC to see what can be done.
- Speed Calming - We don't want it but if people don't slow down, particularly on Meaux Road there could be a serious accident.
- Speed Survey - We have asked ERYC to update the figures they are using as we don't think they represent the current road use situation.

CCTV

Having met the expert from the EYRC regarding the regulations covering CCTV and the legal implications around the way images are retrieved and stored we have decided not to go ahead with CCTV at the first bend along Meaux Road.

Part of the Recreation Ground refurbishment plan is to include comprehensive CCTV coverage and we feel this will be a better utilisation of our funds.

Dog Fouling

The area just behind the Village Hall is not open fields - its land cared for by the Village Hall committee so please don't allow your dog to foul this area.

We have installed a waste bin and dog poo bag dispenser in this area to help those of you that have forgotten to take bags with you.



Wawne
Parish Council
Here for you
www.wawneparishcouncil.co.uk

Recreation Ground

There are many names for the land along Ferry Road - 'Cricket Field' (you must be over 40!) the Play Area etc.

With our plans for fresh start we want to start referring to this as the Recreation Ground - the site needs to be more inclusive, more widely used and encompass the traditional role of a sport area in a more modern way - an outside gymnasium for all ages!

We have a short and long term plans

- Spend precept or grant monies and get the play area back open in July/ August

- Spend grant monies and commuted sums (monies linked to the new build sites) to revamp the whole site

We have a sub-committee planning out the new site and applying for the funding from the many sources available.

We need to have a plan to go before the EYRC funding body in November this year - the sub-committee is aiming for work to start early 2020 but completion may have to be in any number of phases depending on how the monies are made available.

Ideas so far - Move the play area to the main field and update with CCTV, climbing frames, zipwire, roundabout, seesaw, picnic area, bins, seating, etc. a dog park, a woodland, wood sculptures, goal post, games area (football, basketball, tennis) lighting, an outdoor gym and pavements to the ground itself.

If you have a spare £100,000 please get in touch with Councillor Jacob Birch who is Chairman of the sub-committee on behalf of the Parish Council.

On the following pages you will see some provisional designs and plans. These are drafts put together to help the Sub - Committee see what the Recreation Ground could look like.



EQUIPMENT LIST

01	Abacus Spine	11	Zip Line Double
02	Viper Rope Swing	12	The Top of the World Ball Play Platform
03	Dark Overhead Climber	13	Talk Tables
04	UchiWay Offroad	14	Picnic Area
05	UchiWay Jumbo	15	Blaze Climber Stack
06	Baller Swing with Two Poles and 8 Seats - Tropic Isle	16	Reptile Climbing Area
07	Wavy Bounceabout	17	Shin Massage Seals
08	Prosecco Spinner	18	Shin Massage Platform
09	Upping Presser	19	Shin Football Club
10	Prosecco Double Springer		

© 2014 The Play Matters Company
www.playmatters.com

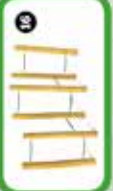
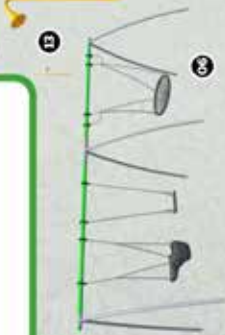
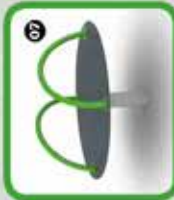
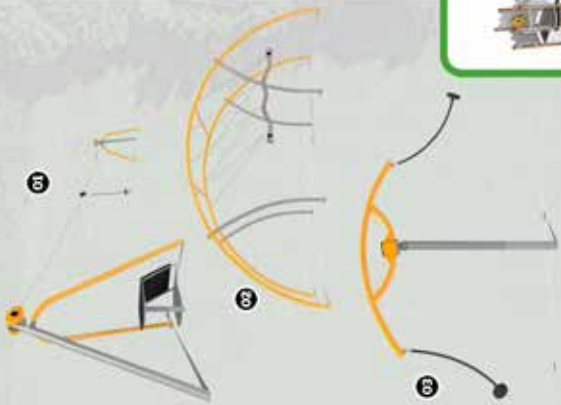
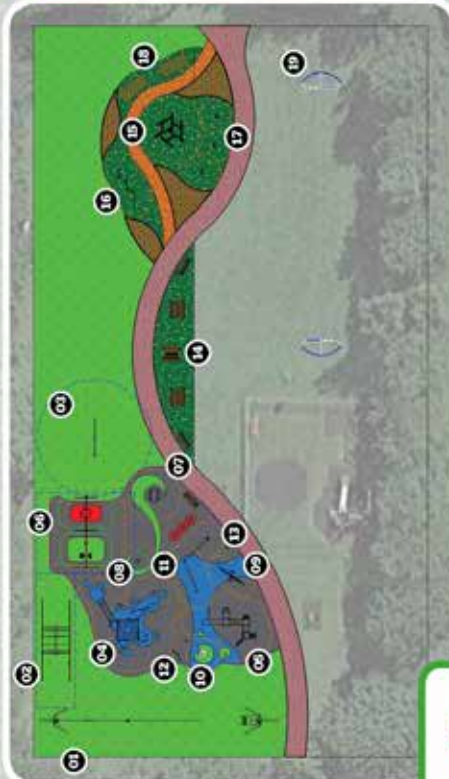

Taking a stand against scams



Join us at our Friends Against Scams Awareness
event on Tuesday 30th July 2019
at Wawne Parish Council at 5pm -6.30pm.

RSVP: Amanda Smith

Email: amanda.smith@natwest.com

Tel: 07711 764397

We are what we do

You can also RSVP to the Clerk or Cllr Birch

01482 225241

clerk@wawneparishcouncil.co.uk



NatWest

Poem

Packaging

Lids and packaging today,
Will send me round the bend,
Despite a bunch of 'helpful' tools,
The problem never ends.
To open a bottle of water
Is it too much to ask?
That without the aid of a spanner
I can't perform this mundane task.
Even a harmless jar of jam,
For tea in the afternoon,
Can cause the strongest macho man,
To prise it with a spoon.
Press and turn the lid on bleach,
Sounds easy as can be,
It kills 99% of household germs,
And it's nearly killing me.
Those little sachets of condiments,
Cause my blood pressure levels to raise,
Faced with a juicy salad,
I can't open the mayonnaise.
All these childproof wonders,
As far as I can see,
Are simply not just child proof,
They're proof from you and me!

Margaret Crossland

FOWSA

Following the success of last year's afternoon Tea Party/Bakesale we will be running the Café again this year at 'Wawne Fest' Saturday 13th July in the school hall. We will be selling a delicious selection of cakes, buns, sandwiches, sausage rolls along with teas, coffees and Juice.

Please come along and have tea and cake with us... or buy treats to take home.

If you enjoy baking and would like to bake a cake to donate to our school fundraiser, please get in touch with the school.

FOWSA has funded a range of amazing events, trips and items over the previous months.

Such as the fantastic 'Circus Skills Day' the school hall was filled with laughter and noise as the children got involved with learning new skills. It was a memorable and exciting experience.

We funded Year 5 & 6 Mindfulness/Exam stress workshops, Foundation Forest School trip and Year 1 & 2 trip to Tophill Low Nature Reserve as part of their topic work looking at habitats and the environment, the children took part in pond dipping, bird watching and a nature detective walk.

We have also just supplied every child with a new team T-shirt in their team colours. The teams are named after the 5 Olympic Rings Blue, Yellow, Black, Red and Green. The children will take part in team days and activities to build relationships and team spirit.

All the children are looking forward to the Big Sing in July at the Bridlington Spa.

FOWSA work extremely hard to support the above events and raise money for the school so that the children can have more opportunities and experiences to support their learning journey.

Sadly the number of members has dwindled recently, so if you are a parent or carer with a little spare time and would like to support this great resource please get in touch with the school.



Village Hall

We have had a small gathering to do a health & hygiene course with the East Riding college. This included a section on allergens - didn't know there were so many. Celery and Lupins !! ?? Who'd have thought it. As well as all the well known ones, of course. So now most of us are up to date with our certifications we won't be poisoning anyone.

That's good news as we're doing Home Produce to sell at the Fest. This includes jams, pickles, tarts, quiches, sausage rolls, meat pasties & pies, as well as cakes & fresh scones.

There will also, on a separate table, be succulents in decorative pots & cotton hanging baskets.

Viv is doing a game for young people which went down very well last year. Prizes will include small soft toys.

Everything at the Hall is continuing satisfactory and we hope it will continue to do so.

Have a great Summer, and I hope you didn't suffer too much with the thunderstorms.

Barbara Hodgson.

Prince and Princess Competition

Wawne Fest Saturday 13th July 2019

Entree Form

Calling all budding Prince and Princesses, this is your chance to be crowned!

The Wawne Festival Committee are looking for Boys and Girls who are 'Regally' dressed to enter the competition at the 2019 Wawne Fest.

The winners will take part in next year's parade and in the opening ceremony of the fest, receive a Sash and Rosette and a "Love to Shop Voucher"

The winners will be chosen by a Special Guest

Please let me know if you will be participating at the Fest.

Prince or Princess Name: _____

Age: _____

Parent / Guardian name: _____

Contact Number: _____

Address: _____

Please either complete and send to:

4 Ferry Road, Wawne, Hull, HU7 5XU

Or email the above details to wawnefestival@gmail.com



Wawne Fest 2019 RAFFLE

Tickets will be **SOLD** and **DRAWN** on **Saturday 13th July**

Spectacular Prizes

Creme D'or Luxury Confectionary & Fine Food Hampers

Fabulous Gifting Hamper

Sledmere House Tickets

Jorvic Viking Centre Tickets

Castle Howard Tickets

The Deep Family Ticket

Wilko £10 Gift Card

Style Studio Gift Card

Coletta & Tyson Welcome Plaque & Window Bird Feeder

Parkway £10 Voucher

£25 Asda Gift Card

SAKS at David Lloyd - Neck and Shoulder Massage

Plus many more...

**£1
Per
Ticket**

Wawne Fest

13th July 2019

Lancaster Bomber Flypast

Great news! We have recently been informed that we will be getting a flypast by the only flying Lancaster Bomber in the UK from the Battle of Britain Memorial Flight. It is certainly something not to miss so come to the Fest and if you can please publicise it via your social media contacts. It will be a fantastic sight and sound.

Extract from the RAF Display team website: <https://www.raf.mod.uk/display-teams/>

“The Royal Air Force Battle of Britain Memorial Flight (BBMF) operates from RAF Coningsby, a Typhoon and fighter base, in Lincolnshire. The mission of the RAF BBMF is to maintain the priceless artefacts of our national heritage in airworthy condition in order to commemorate those who have fallen in the service of this country, to promote the modern day Air Force and to inspire the future generations.

Flown by regular serving RAF Aircrew, the Flight operates six Spitfires, two Hurricane Mk 2Cs, a Lancaster as well as a C47 Dakota and two Chipmunk aircraft (primarily used for training).

From May to September each year, these aircraft can be regularly seen in the skies over the UK celebrating and commemorating public (Wawne Fest!!) and military events from State occasions such as Trooping the Colour to major air displays and simple flypasts for public events. We are proud to have HRH Prince William, Duke of Cambridge as our Patron.

The motto of the RAF BBMF reflects our mission and honours the thousands of men and women, in the air and on the ground, that gave their lives for this country in the noble pursuit of freedom.”

“Lest We Forget”

It's nearly time for the FEST - are you ready to PARTY?

Planning for the next Wawne Fest is complete and we look forward to a great local band called Tin Soldier to really get the Fest going. They are a great sound and perform a wide variety of music so bring along your dancing shoes and join in.

A magician, Mad Magic, will be performing for your entertainment and will also walk around, showing individuals some amazing magic. You might even pick up some clues on how the magic happens!

We also have dancers, Army Cadet Marching band, Archery, bouncy castle, sand pit, soft play (for under 5yrs), ball pit, Funny Photo Booths, balloons, face painting, classic cars and tractors, old equipment, animals display, food, cafe, bar and more. In addition there will be a flypast by the RAF BBMF Lancaster - Fantastic - not to be missed.

Don't forget to enter for the Prince and Princess competition were the winners will take part in next years Fest and receive a voucher.

In this publication over the last two editions I have written articles regarding David Ayres and the memorial cup donated by his family in his name and the competition we are holding were the winners will be presented with the cup which they will keep until the next Fest. The competition, in keeping with David's love of engineering, was to design and make a useful creative invention. I hope you have been busy and look forward to your entries.

To help with fund raising to support the Fest and in addition to a raffle we will be running a tombola and we have received many prizes from residents. Many thanks to all who donated.

In the last two Wawne Gazettes I have asked for anyone who could help with the physical setting up and taking down of the Fest to let me know. I am disappointed to announce that NO ONE has contacted me! The Fest is reliant on volunteers and we are very grateful to the small group of regulars that help. You know who you are so a big thanks to you. This is another plea for assistance and any help you can give in the setting up, running and

clearing away will be greatly appreciated. We start setting up at the school on Wednesday 10th July (from 6pm) and continue on Friday 12th July (from 4.30pm) and then the Fest day on the 13th (from 9am until final clearance). Any help would be great but especially the final clearance of the school and field after the Fest so that it is ready for the children on the Monday.

In the January/February Wawne Gazette I informed you that the next Fest could be the last one which after 67 years would be a shame and the loss of a great village tradition. The planning and running of the Fest relies on a volunteer committee where some members have been helping for many years and one since the 'Show' started 67 years ago! To preserve the Fest we need new, enthusiastic members who will continue this great annual event. Do you enjoy the Fest and want to see it continue? Then please contact me. I am happy to discuss the requirements and help.

Please note that dogs are not allowed at the Fest except Guide dogs and official photos will also be taken and may be published.

I would like to thank the school and Governors for letting us use the school and for their support.

I LOOK FORWARD TO SEEING YOU AT THE FEST.

Martin Bengé
Chair, Wawne Festival Committee
4 Ferry Road, Wawne
Tel: 834095
wawnefestival@gmail.com

The Wawne Fest is non profit making. No one is paid and the event has to be self financing which includes grateful donations and sponsors. If you would like to donate please let me know. Note: This years fixed costs are almost £2000.

St Peters Church

Dear Friends in Wawne,

I always find it humbling to go into St Peter's and think of the people who, over 900 years, have come into the church, found renewed strength through their faith, and have loved and cared for the church, passing it on to the next generation. It's a physical testimony to their faith.

In the churchyard the stonemason is still in the process of adding the name of Arthur Bromby to GW Brown's War Memorial, and we plan to have a dedication of the memorial when complete. And on the subject of war, now that we have a flagpole on the ground again, instead of only on top of the tower, we fly flags at important church or national dates. So for instance, thanks to Derek Brown in the village, the Union Jack flew recently for the D Day anniversary.

I gather that some people did not receive the Gazette last month, so I am repeating my request for anyone to contact me who would like to help keep the churchyard smart. You could do as much or as little as you fancy!

We are still awaiting the double yellow lines along the road outside the church. We were promised these two years ago, and look forward to their arrival as we want to avoid traffic flow problems because of special church services. In the meantime, we put out cones and I even ask people to move their cars if they are parked inconveniently. We are on your side!

We have a service in church virtually every Sunday at 11am, and for those who find Sundays difficult, we have one on the first Wednesday of each month at 9.30am. And in July we are holding a Cream Tea event again, in church or on the lawn in the sun outside, on Saturday 6 June from 2.30 to 4.30pm. We hope that it will be accompanied by an exhibition of paintings of East Riding churches, by Jan Tomlinson.

You can find more information on our church website at suttonparkandwawnechurchofengland.co.uk

And if you are a fan of Facebook, you can find our page by putting in St Andrew's Church, Sutton Park and St Peter's, Wawne.

Best wishes,
Chris van Straaten
Email: cjvanstraaten@gmail.com



Joyce Yates' Brownies

Many people admired the brownies after Joyce's funeral. They were made to her recipe, so here it is, from Gabrielle:

7 oz self raising flour
4 oz dark brown sugar
3 oz margarine
3 oz black treacle
1 egg beaten with 3 fl oz milk.

Melt the sugar, marg and treacle together (either in a microwave taking care not to burn the sugar/treacle) or in a pan on a hob over a low heat, then beat in the egg and milk and stir in the flour.

Bake at 325 F (160 C) for approx 35 mins or until the cake springs back when pushed with a finger !

In loving memory of Joyce Yates.

Many thanks to Chris van Straaten

Wawne Bowls club



Ever wanted to have a game of bowls? Well now here is your chance!

The Club are currently looking for new members and would like to invite you to come along to a Bowls Club session.

Monday Afternoons 1pm to 3pm

Tuesday Nights 7pm - 9pm

Friday Mornings 10am - 12noon

Sunday Mornings 10am - 12noon

WAWNE VILLAGE HALL

"The sport of bowls is suitable for all ages and is good for your physical and Mental health. Plus it is a great way to make new friends"

All equipment is provided, but bring soft shoes (or stocking feet!)

For more information contact Don 01482 822233

OR JUST TURN UP!

WAWNE GAZETTE ADVERTISING SPACE AVAILABLE

Circulates 500 copies 6 times a year

Half page per issue - £10

Full page per issue - £20

SAVE £20!

Full Page Subscription - £100 (Saving £20) - 6 Issues

SAVE £10

Half Page Subscription - £80 (Saving £10) - 9 Issues

cllr.birch@wawneparishcouncil.co.uk



WE WILL SELL YOUR HOUSE!

Whilst Taylor's Estate Agents is a new, vibrant brand within the local property sector, its directors, Chris Hall and Gemma Bolder are no strangers to the property market having over 30 years combined experience within the industry.

Director Chris Hall already owns an established letting agency – JKT Property, which is also based in Sutton, and has always wanted to add a 'sales arm' to the business. With this in mind he and Gemma developed Taylor's Estate Agents.

"We believe in a culture of honesty, trust and transparency, which underpins everything we do. JKT Property was built much the same way and is now going into its 16th year of business," says Chris.

Taylor's make selling your home easy and stress free, with a fixed fee, so sellers know exactly how much it will cost them and are so confident that they can sell your home for you that they also offer a 'No sale, no fee'.



Call Taylor's Estate Agents today on **01482 705898** www.taylorsofthull.co.uk

Registered Offices: 5a College Street, Sutton on Hull, East Yorkshire, HU7 4UE



WHO'S EYEING UP YOUR PROPERTY?

SECURE IT LOCK IT OR LOSE IT!

Opportunist burglars use an open
door or window

- ◆ A visible company logo bell deters.
- ◆ Install CCTV so you are looking at them.
- ◆ Secure all windows, doors and sheds.

L

LINSNER SECURITY

- ◆ WIRELESS INTRUDER SYSTEMS
- ◆ CCTV SYSTEMS
- ◆ GATE INTERCOM SYSTEMS
- ◆ EXTERNAL BUILDINGS SYSTEMS



CCTV

LINSNER SECURITY SYSTEMS

T: +44(0)1964 564 272 **M:** +44(0)7914 419 425

E: info@linsnersecurity.co.uk **W:** www.linsnersecurity.co.uk

Field View | 23 The Hawthorns | Long Riston | Hull | HU11 5GA

DS MOWERS

Formally of East Hull Lawnmowers



Servicing of lawnmowers in Wawne
and surrounding areas,
“free collection”

Contact David on: 07549 669990



MEADOWS JOINERY SERVICES

For all aspects of Joinery

Flooring Specialists - Karndean, Solid
Wood and Laminate Flooring.

Supplied and fitted or fit only

01864 644303 / 07867 554828

www.meadowsjoineryservices.com

Please contact: Mick Parsony, Luton



Menu
SERVED

Brunch & Main Menu

Monday - Saturday 12pm - 7pm

Main Menu Only

Sunday 12pm - 5pm

Children welcome in the Lounge areas till 7pm

Snacks / Hot & Cold Drinks / Ice Creams / Desserts



Bar Open's 10.00am - Midnight

Bar area shows SKY SPORTS

Karaoke Friday from 4pm

Tuesday Club from 4pm £5.00 entry

all welcome for an afternoon of fun!



The Meadows Public House
100 Minshel Road

Brantholme

Hull

HU7 4HA

01482 877445

Wawne Stores & Post Office

 Like Us On
Facebook

52 Main Street
01482 825058



OPENING HOURS

7am - 8pm - Monday to Saturday
7:30am to 1pm - Sundays & Bank Holidays

Post Office

9am - 5:30pm - Monday to Friday
9am - 12:30 - Saturday

More Than You Might Expect!